

## Standard Vibration dampers

### Dimensions

Type 2

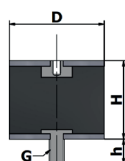

D	H	G
6	7	M3xh/M3
8	5	
8	8	M3xh/M3
8	10	
9	12	M3xh/M3 M4xh/M4
10	8	M3xh/M3
10	10	M4xh/M4
10	15	M3xh/M3
10	17	M4xh/M4
10	18	M5xh/M5
10	30	
11	11	M3xh/M3 M4xh/M4
12	10	M3xh/M3 M4xh/M4
13	26	M4xh/M4 M5xh/M5 M6xh/M6
15	4	
15	5	
15	6	
15	7	
15	8	M4xh/M4
15	9	
15	10	M4xh/M4
15	12	M5xh/M5
15	13	
15	15	
15	20	
15	25	
15	30	
16	18	M4xh/M4 M5xh/M5
20	5	
20	8	
20	10	M5xh/M5 M6xh/M6
20	11	M5xh/M5
20	12	M6xh/M6
20	13	
20	15	M5xh/M5
20	17	M6xh/M6
20	20	M8h/M8
20	23	
20	25	
20	30	

# VIBRATION DAMPERS

## Dimensions

Type 2

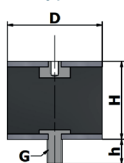

D	H	G
25	8	
25	10	
25	12	
25	13	
25	14	
25	15	M6xh/M6
25	17	M8xh/M8
25	18	
25	19	
25	20	
25	22	
25	25	
25	27	
25	28	
25	30	
26	22	M6xh/M6 M8xh/M8
30	8	
30	10	
30	12	
30	13	
30	15	M6xh/M6
30	17	M8xh/M8
30	18	M10xh/M10
30	20	
30	22	
30	25	
30	30	
30	35	
30	45	
30	40	
40	10	
40	15	M6xh/M6
40	20	M8xh/M8
40	25	M10xh/M10
40	27	
40	28	
40	30	
40	35	M6xh/M6
40	38	M8xh/M8
40	40	M10xh/M10
40	45	
40	60	
50	7	
50	9	
50	12	
50	15	
50	17	
50	20	M8xh/M8
50	21	M10xh/M10
50	25	M12xh/M12
50	27	
50	28	
50	30	
50	35	
50	37	
50	40	
50	42	
50	45	
50	50	
50	80	

# VIBRATION DAMPERS

## Dimensions

Type 2

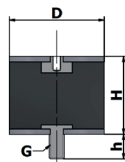

D	H	G
60	15	
60	16	
60	20	
60	25	M8xh/M8
		M10xh/M10
60	30	M8xh/M8
60	35	M10xh/M10
60	40	M12xh/M12
60	45	
60	50	
60	60	
65	35	M12xh/M12
70	20	
70	25	
70	30	M10xh/M10
70	35	M12xh/M12
70	40	
70	45	
70	50	
70	53	
70	55	
70	60	
70	70	
75	20	
75	25	M10xh/M10
75	30	M12xh/M12
75	35	
75	40	
75	45	
75	50	
75	55	
75	60	
75	70	
75	100	
80	17	M10xh/M10
80	18	M12xh/M12
80	30	M14xh/M16
80	40	M14xh/M16
80	50	
80	55	
80	60	
80	65	
80	70	
80	75	
80	80	
90	60	M12xh/M12
100	25	
100	30	
100	35	
100	40	M12xh/M12
100	45	M16xh/M16
100	50	
100	55	
100	60	
100	65	
100	70	
100	75	
100	80	
100	100	
150	50	
150	55	M16xh/M16
150	60	M20xh/M20
150	75	
200	100	M20xh/M20

# VIBRATION DAMPERS

## Thread lengths (h)

<b>G</b>	<b>(h) mm</b>
<b>M3</b>	4, 6, 10
<b>M4</b>	6, 8, 10
<b>M5</b>	10, 12, 15
<b>M6</b>	6, 8, 10, 12, 15, 18, 20, 23, 28
<b>M8</b>	8, 10, 12, 15, 18, 20, 23, 25, 28, 33
<b>M10</b>	10, 12, 15, 18, 20, 23, 25, 28, 33, 38, 43
<b>M12</b>	10, 12, 18, 20, 23, 25, 27, 33, 37, 42
<b>M16</b>	26, 36, 41, 46
<b>M20</b>	41, 45